

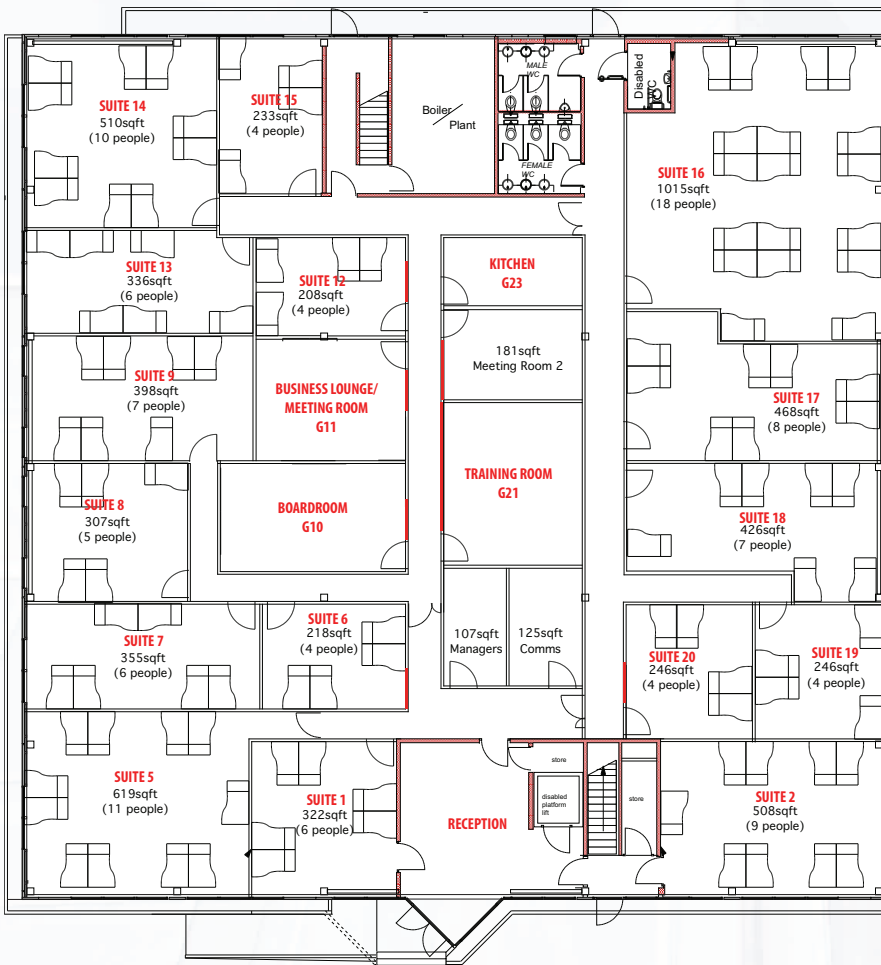

FORSYTH HOUSE

39 MARK ROAD • HEMEL HEMPSTEAD • HP2 7DN

GROUND FLOOR LAYOUT



Suite 1	322 sq ft	6 people
Suite 2	508 sq ft	9 people
Suite 5	619 sq ft	11 people
Suite 6	218 sq ft	4 people
Suite 7	355 sq ft	6 people
Suite 8	307 sq ft	5 people
Suite 9	398 sq ft	7 people
Suite 10	BOARDROOM	
Suite 11	BUSINESS LOUNGE	
Suite 12	208 sq ft	4 people
Suite 13	336 sq ft	6 people
Suite 14	510 sq ft	10 people
Suite 15	233 sq ft	4 people
Suite 16	1015 sq ft	18 people
Suite 17	468 sq ft	8 people
Suite 18	426 sq ft	7 people
Suite 19	246 sq ft	4 people
Suite 20	246 sq ft	4 people
Suite 21	TRAINING ROOM	
Suite 22	MEETING ROOM 2	

Viewing & Further Information

For further details on current availability and viewing arrangements, please contact:

Managed by:

Claire Madden





FORSYTH HOUSE

39 MARK ROAD • HEMEL HEMPSTEAD • HP2 7DN

FIRST FLOOR ILLUSTRATIVE LAYOUT

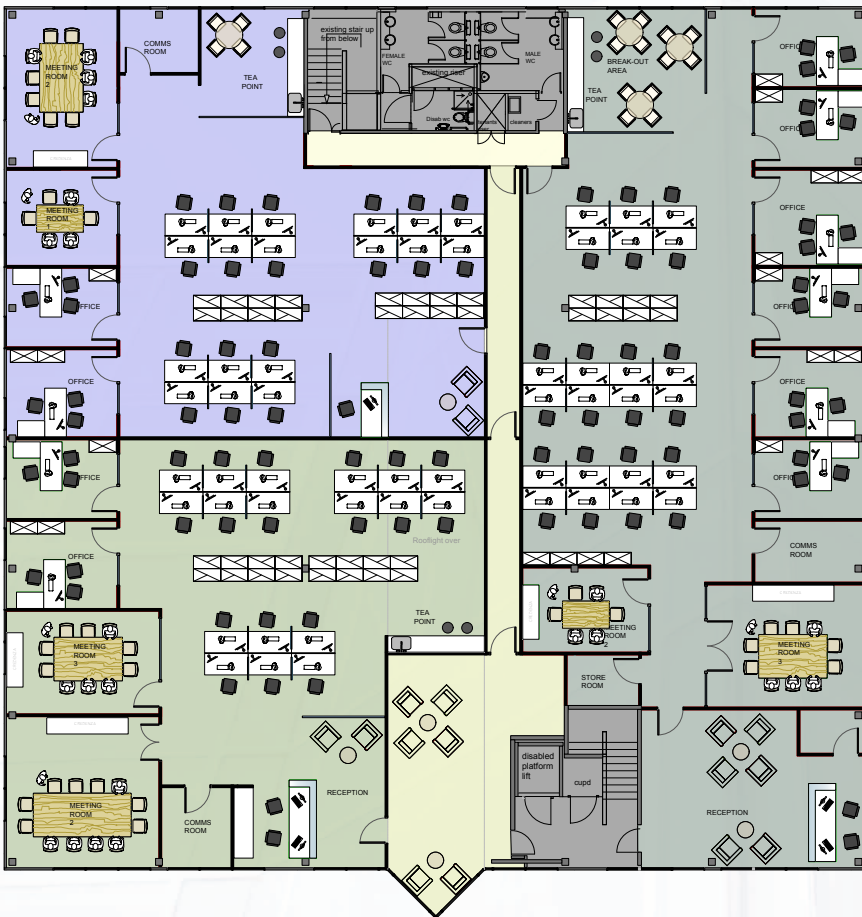

PLEASE NOTE THE PARTITIONING IS INTENDED AS A GUIDE ONLY, AND SUITES ARE AVAILABLE FROM 2,417 - 9,670 SQ FT EITHER INDIVIDUALLY OR COMBINED.



Viewing & Further Information

For further details on current availability and viewing arrangements, please contact:

Managed by:

Claire Madden

